

Ordering Code: **ML-11A3-X-Y 01-Z**

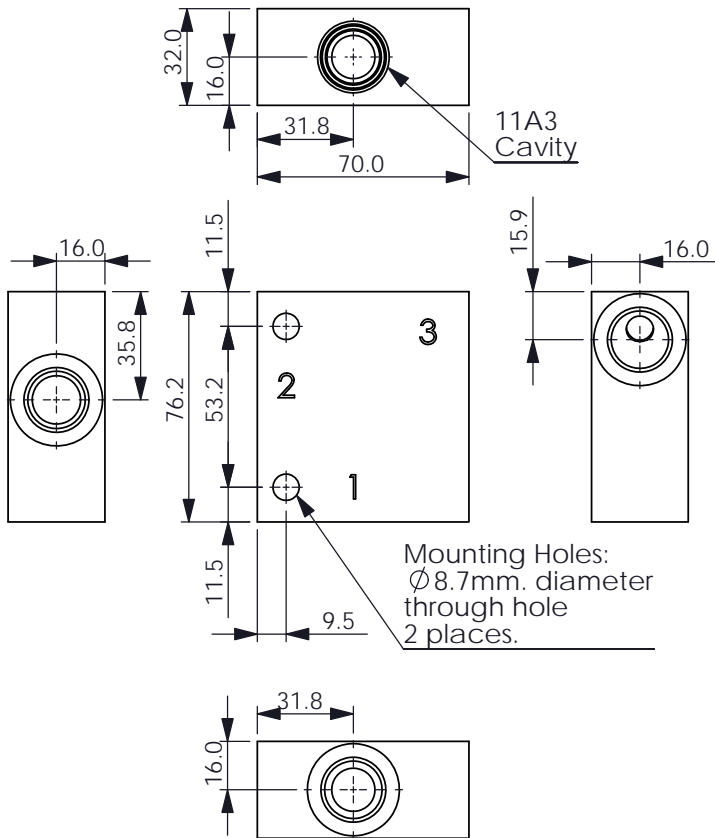

UNIT:mm

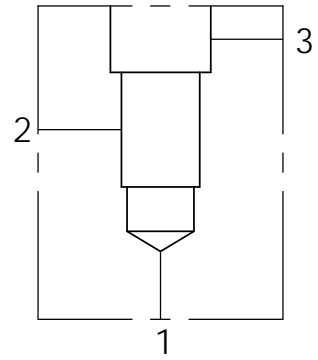
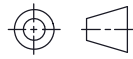

TECHNICAL DATA

Aluminum Body Pressure Rating: 210 bar
Ductile Iron
Body Pressure Rating: 350 bar

Cavity:

Refer to 11A3

* Refer to Winner Cartridge Valves Catalog.

Aluminum	0.37 kg(WITHOUT VALVES)
----------	-------------------------

Ductile Iron	0.97 kg(WITHOUT VALVES)
--------------	-------------------------

* If you need the special specification.
Please contact us.

PORT SIZE

X	PORTS	PORT	
	1,2	3	
G04	G 1/2"	G 1/2"	

Y BODY MATERIAL

A HIGH-STRENGTH ALUMINUM

S DUCTILE IRON

Z CARTRIDGE VALVES SELECTION

WITHOUT VALVE

PP0A PP11A30AL (40LPM,7-210bar)

PD0A PD11A30AL (40LPM,35-210bar)

The selection is only example. Please refer to Winner Cartridge Program and to select the appropriate valves and manifolds assembly in accordance with request function (flow \ pressure \ ... etc.)