

Ordering Code: **ML-11A3-X-Y 02-Z**

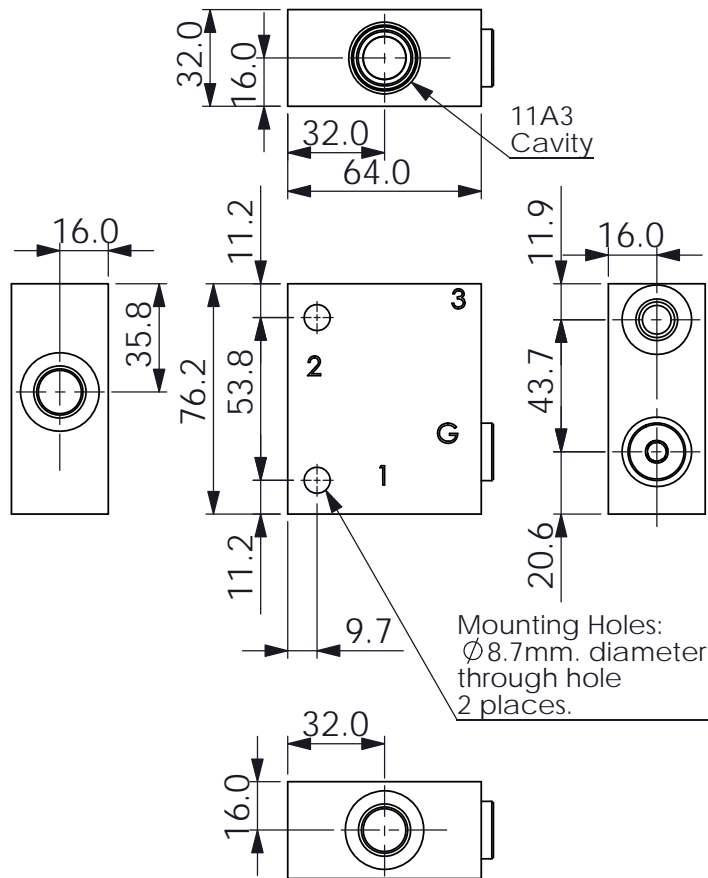

UNIT:mm

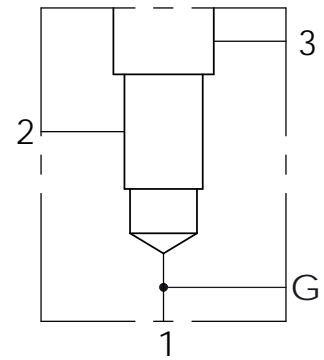
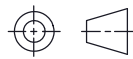

### TECHNICAL DATA

Aluminum Body Pressure Rating: 210 bar  
Ductile Iron Body Pressure Rating: 350 bar

Cavity:

Refer to 11A3

\* Refer to Winner Cartridge Valves Catalog.

Aluminum	0.35 kg(WITHOUT VALVES)
Ductile Iron	0.97 kg(WITHOUT VALVES)

\* If you need the special specification. Please contact us.

X	PORT SIZE		
	PORTS	PORT	PORT
	1,2	3	G
G03AG	G 3/8"	G 1/4"	G 1/4"
S06G	SAE 6	SAE 6	1/4"NPT

Z	CARTRIDGE VALVES SELECTION	
	WITHOUT VALVE	
RV0A	RV11A30AL(60LPM,7-210bar)	
CB3H	CB11A33HL (60LPM,70-280bar)	
CO20	CO11A3020N (60LPM,2.0bar)	
CC20	CC11A3020N (60LPM,2.0bar)	
SPOA	SP11A30AL (60LPM,7-210bar)	
PBOA	PB11A30AL (40LPM,7-210bar)	

The selection is only example. Please refer to Winner Cartridge Program and to select the appropriate valves and manifolds assembly in accordance with request function (flow 、 pressure 、 ... etc.)

Y	BODY MATERIAL	
A	HIGH-STRENGTH ALUMINUM	
S	DUCTILE IRON	