

Ordering Code: **ML-16W4-X-Y 11-Z**

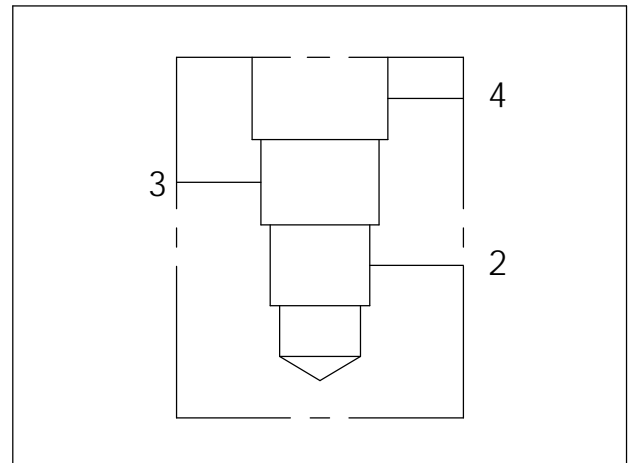
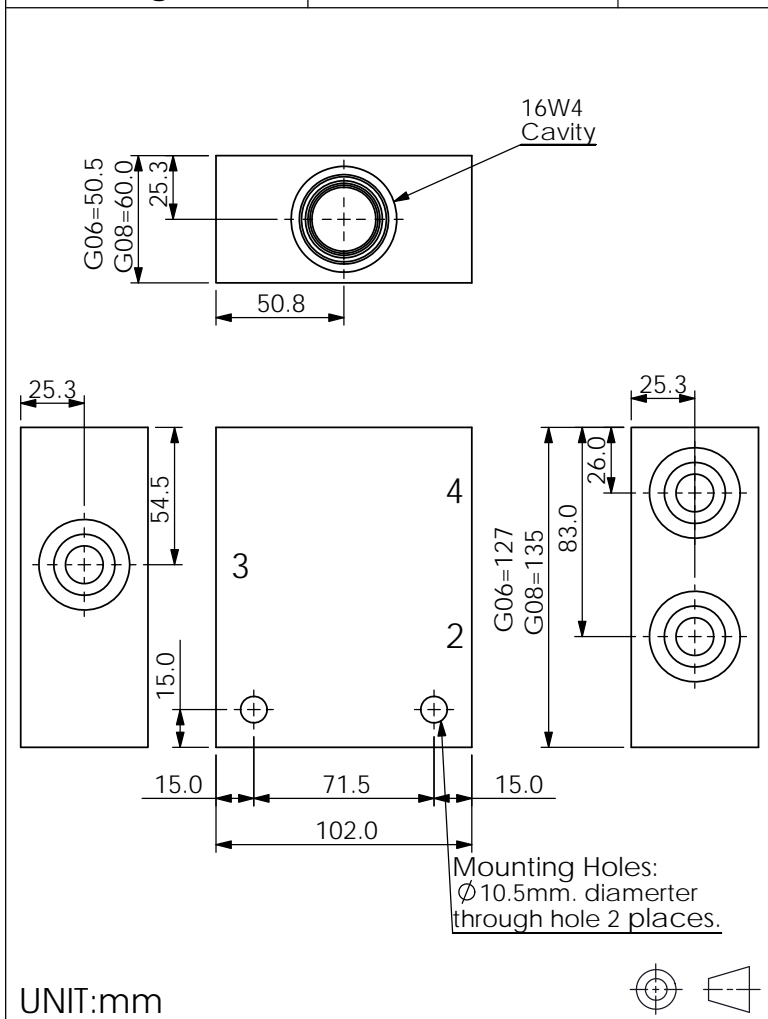

TECHNICAL DATA

Aluminum Body Pressure Rating: 210 bar
Ductile Iron Body Pressure Rating: 350 bar

Cavity:

Refer to 16W4

* Refer to Winner Cartridge Valves Catalog.

Aluminum	1.42 kg(WITHOUT VALVES)
Ductile Iron	4.2 kg(WITHOUT VALVES)

* If you need the special specification. Please contact us.

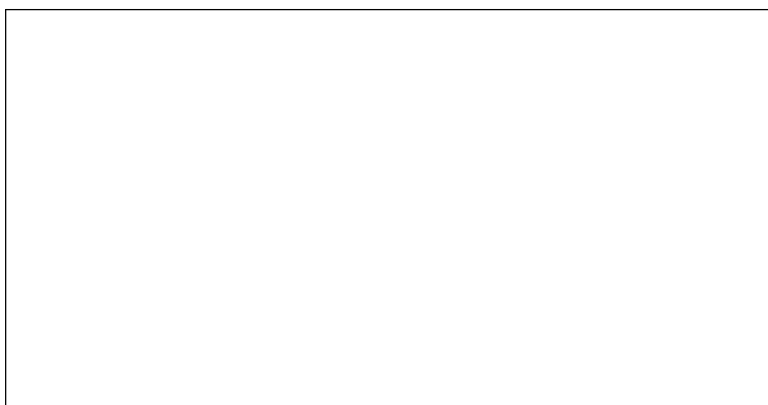

X	PORT SIZE		
	PORTS	PORT	
	2,3	4	
G06	G 3/4"	G 3/4"	
G08	G 1"	G 1"	

Y	BODY MATERIAL	
A	HIGH-STRENGTH ALUMINUM	
S	DUCTILE IRON	

Z	CARTRIDGE VALVES SELECTION	
	WITHOUT VALVE	
FD90	FD16W4090N(30-90LPM,10-350bar ,RATIO 50:50)	

The selection is only example. Please refer to Winner Cartridge Program and to select the appropriate valves and manifolds assembly in accordance with request function (flow 、 pressure 、 ... etc.)