

Ordering Code: **ML-17A3-X-Y 01-Z**

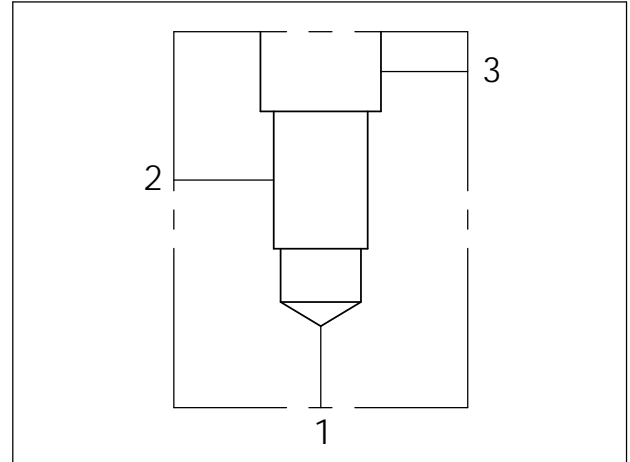
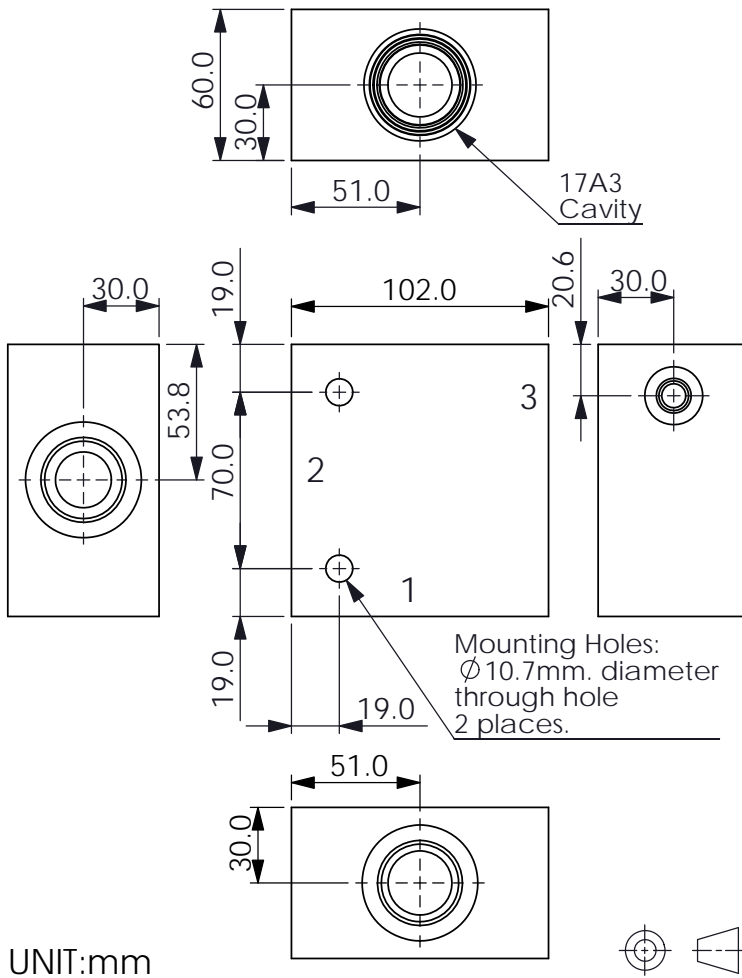

TECHNICAL DATA

Aluminum Body Pressure Rating: 210 bar
Ductile Iron Body Pressure Rating: 350 bar

Cavity:

Refer to 17A3

* Refer to Winner Cartridge Valves Catalog.

Aluminum	1.5 kg(WITHOUT VALVES)
Ductile Iron	4.2 kg(WITHOUT VALVES)

* If you need the special specification. Please contact us.

PORT SIZE

X	PORTS		
	1,2	3	
G08A	G 1"	G 1/4"	
G10A	G 1-1/4"	G 1/4"	
S16A	SAE 16	SAE 6	
P03	3/8"PT	3/8"PT	

Z CARTRIDGE VALVES SELECTION

WITHOUT VALVE	
RV0A	RV17A30AL (240LPM,7-210bar)
CBCH	CB17A3CHL (3:1,70-280bar)
CO20	CO17A3020N (240LPM,2.0bar)
CC20	CC17A3020N (320LPM,2.0bar)
PBOA	PB17A30AL (160LPM,7-210bar)
SPOA	SP17A30AL (240LPM,7-210bar)

The selection is only example. Please refer to Winner Cartridge Program and to select the appropriate valves and manifolds assembly in accordance with request function (flow 、 pressure 、 ... etc.)

Y BODY MATERIAL

A	HIGH-STRENGTH ALUMINUM
S	DUCTILE IRON