

Ordering Code: **ML-17A3-X-Y 02-Z**

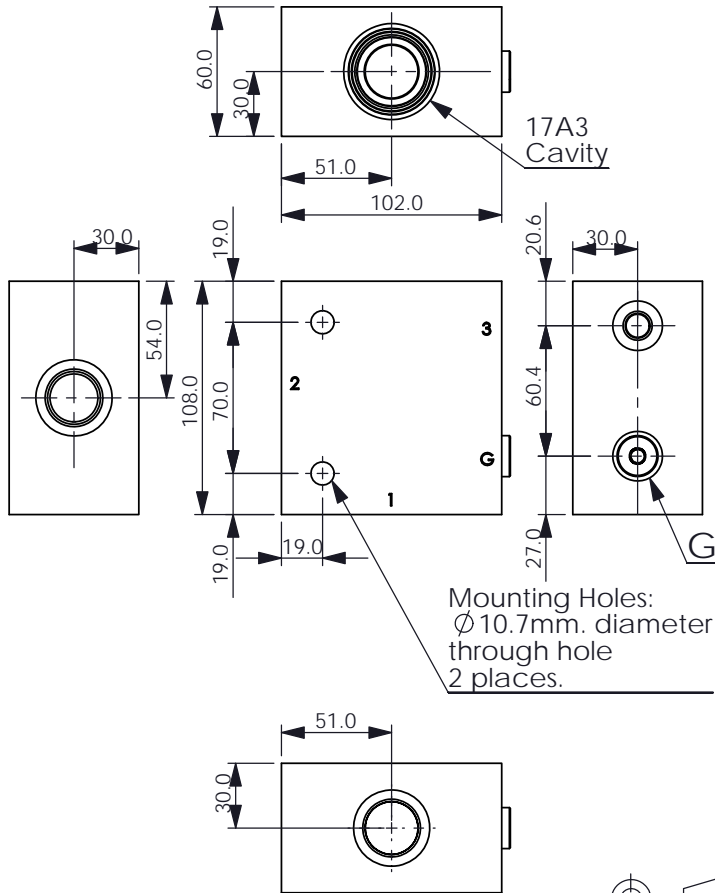

UNIT:mm

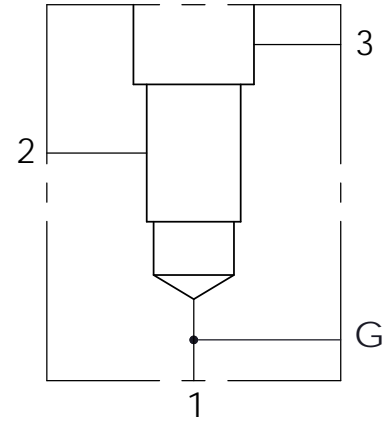

TECHNICAL DATA

Aluminum Body Pressure Rating: 210 bar
Ductile Iron Body Pressure Rating: 350 bar

Cavity:

Refer to 17A3

* Refer to Winner Cartridge Valves Catalog.

Aluminum	1.5 kg(WITHOUT VALVES)
Ductile Iron	4.2 kg(WITHOUT VALVES)

* If you need the special specification.
Please contact us.

PORT SIZE

X	PORTS		
	1,2	3	G
G06AG	G 3/4"	G1/4"	G1/4"
S16AG	SAE 16	SAE 12	1/4"NPT

Z CARTRIDGE VALVES SELECTION

WITHOUT VALVE	
RV0A	RV17A30AL (240LPM,7-210bar)
CBCH	CB17A3CHL (3:1,70-280bar)
CO20	CO17A3020N (240LPM,2.0bar)
CC20	CC17A3020N (320LPM,2.0bar)
PB0A	PB17A30AL (160LPM,7-210bar)

The selection is only example. Please refer to Winner Cartridge Program and to select the appropriate valves and manifolds assembly in accordance with request function (flow 、 pressure 、 ... etc.)

Y BODY MATERIAL

A HIGH-STRENGTH ALUMINUM

S DUCTILE IRON