

Ordering Code: **ML-17A3-X-Y 02-Z**

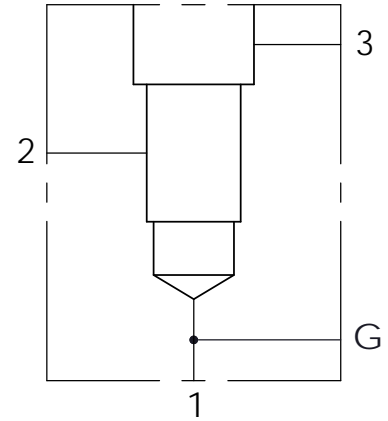
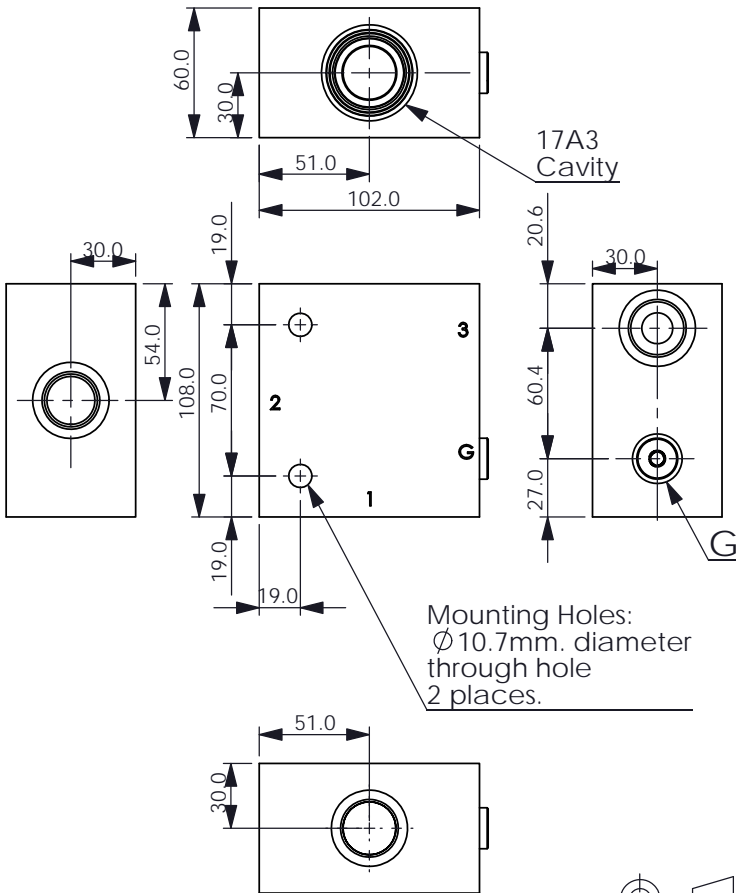

TECHNICAL DATA

Aluminum Body Pressure Rating: 210 bar
Ductile Iron Body Pressure Rating: 350 bar

Cavity:

Refer to 17A3

* Refer to Winner Cartridge Valves Catalog.

| | |
|--------------|------------------------|
| Aluminum | 1.5 kg(WITHOUT VALVES) |
| Ductile Iron | 4.0 kg(WITHOUT VALVES) |

* If you need the special specification. Please contact us.

UNIT:mm

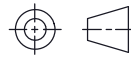

PORT SIZE

| X | PORTS | | |
|------|--------|--------|---------|
| | 1,2 | 3 | G |
| G06G | G 3/4" | G 3/4" | G 1/4" |
| S12G | SAE 12 | SAE 12 | 1/4"NPT |

Z CARTRIDGE VALVES SELECTION

| WITHOUT VALVE | |
|---------------|------------------------------|
| PP0A | PP17A30AL (160LPM,7-210bar) |
| PD0A | PD17A30AL (160LPM,50-210bar) |

The selection is only example. Please refer to Winner Cartridge Program and to select the appropriate valves and manifolds assembly in accordance with request function (flow 、 pressure 、 ... etc.)

Y BODY MATERIAL

| | |
|---|------------------------|
| A | HIGH-STRENGTH ALUMINUM |
| S | DUCTILE IRON |