

Ordering Code: **ML-19A3-X-Y 02-Z**

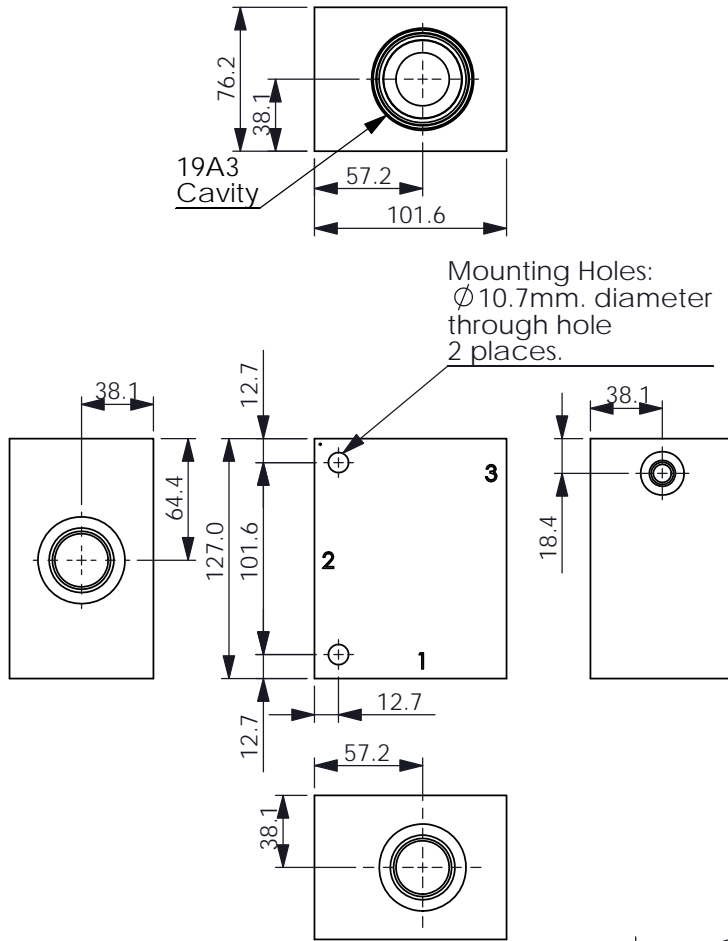

UNIT:mm

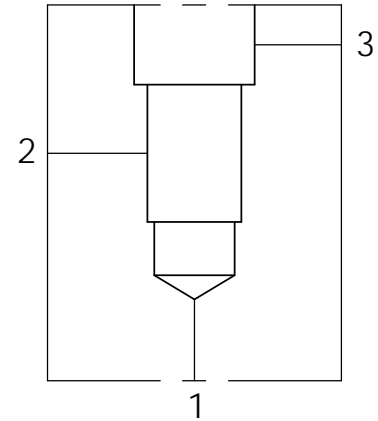

TECHNICAL DATA

Aluminum Body Pressure Rating: 210 bar
Ductile Iron Body Pressure Rating: 350 bar

Cavity:

Refer to 19A3

* Refer to Winner Cartridge Valve Catalog.

Aluminum	2.05 kg(WITHOUT VALVES)
Ductile Iron	5.65 kg(WITHOUT VALVES)

* If you need the special specification.
Please contact us.

PORT SIZE

X	PORTS		
	1,2	3	
G08A	G 1"	G 1/4"	
G10A	G 1-1/4"	G 1/4"	

Y BODY MATERIAL

A HIGH-STRENGTH ALUMINUM

S DUCTILE IRON

Z CARTRIDGE VALVES SELECTION

WITHOUT VALVE

RV0A RV19A30AL (480LPM,7-210bar)

CBCH CB19A3CHL (3:1,70-280bar)

CO20 CO19A3020N (480LPM,2.0bar)

CC20 CC19A3020N (640LPM,2.0bar)

The selection is only example. Please refer to Winner Cartridge Program and to select the appropriate valves and manifolds assembly in accordance with request function (flow 、 pressure 、 ... etc.)