

Ordering Code: **ML-19A3-X-Y 03-Z**

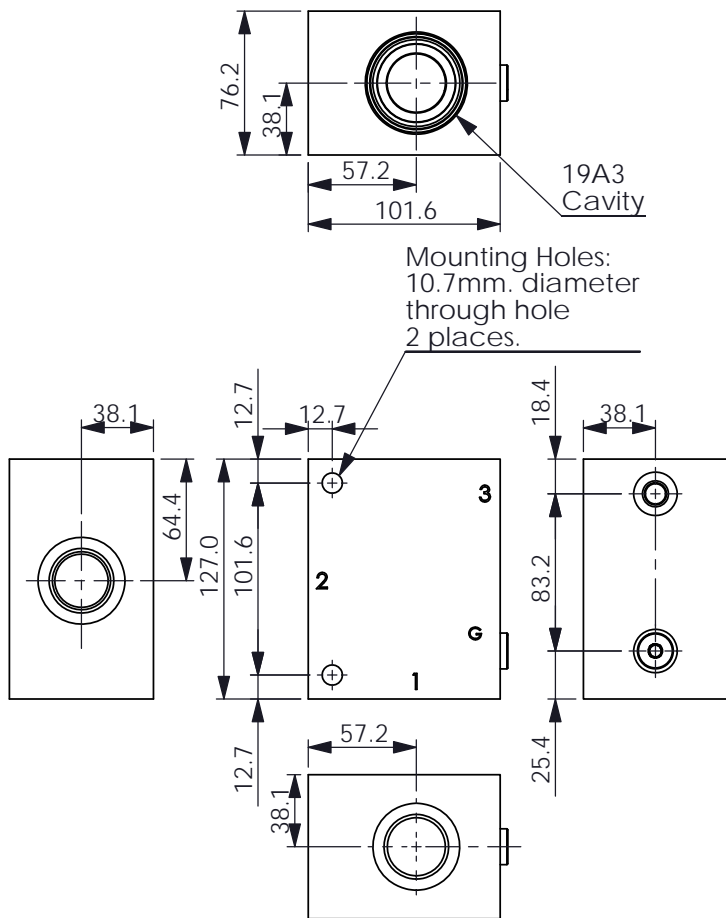

UNIT:mm

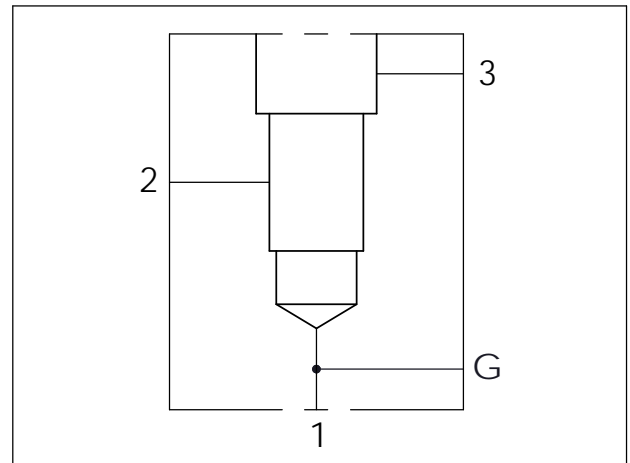
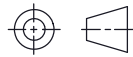

TECHNICAL DATA

Aluminum Body Pressure Rating: 210 bar
Ductile Iron Body Pressure Rating: 350 bar

Cavity:

Refer to 19A3

* Refer to Winner Cartridge Valve Catalog.

Aluminum	2.05 kg(WITHOUT VALVES)
Ductile Iron	5.65 kg(WITHOUT VALVES)

* If you need the special specification.
Please contact us.

PORT SIZE

X	PORTS	PORT	PORT	
	1,2	3	G	
G08AG	G 1"	G 1/4"	G 1/4"	
S16AG	SAE 16	SAE 6	1/4"NPT	
S20AG	SAE 20	SAE 6	1/4"NPT	

Y BODY MATERIAL

A	HIGH-STRENGTH ALUMINUM	
S	DUCTILE IRON	

Z CARTRIDGE VALVES SELECTION

	WITHOUT VALVE	
RV0A	RV19A30AL (480LPM,7-210bar)	
CBCH	CB19A3CHL (3:1,70-280bar)	
CO20	CO19A3020N (480LPM,2.0bar)	
CC20	CC19A3020N (640LPM,2.0bar)	

The selection is only example. Please refer to Winner Cartridge Program and to select the appropriate valves and manifolds assembly in accordance with request function (flow 、 pressure 、 ... etc.)