

Ordering Code: **ML-20WS3-X-Y 01-Z**

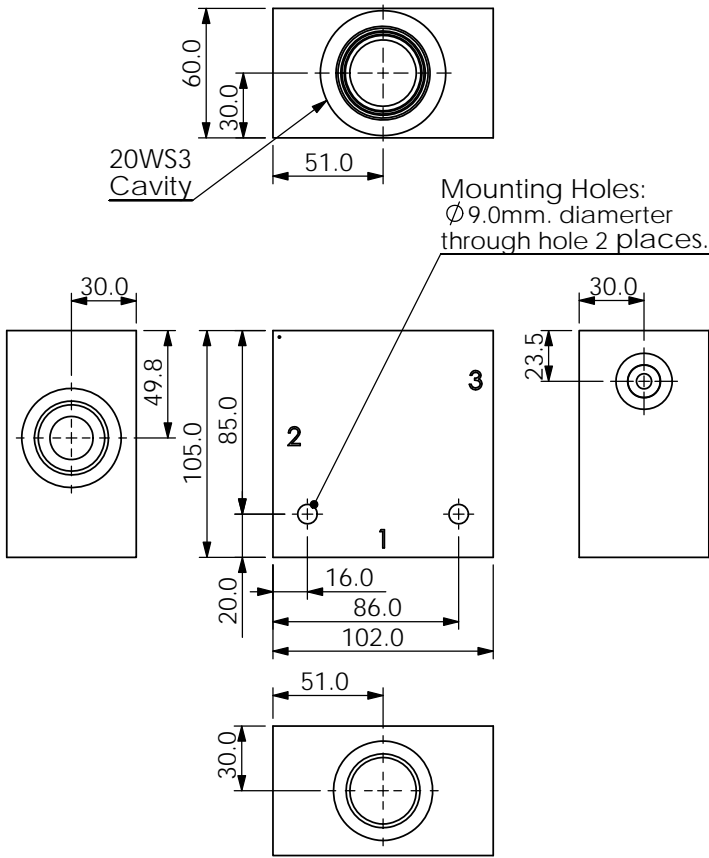

UNIT:mm

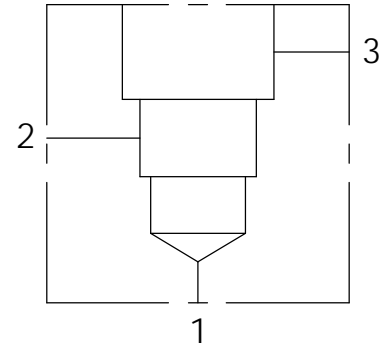

### TECHNICAL DATA

Aluminum Body Pressure Rating: 210 bar  
 Ductile Iron Body Pressure Rating: 350 bar

Cavity:

Refer to 20WS3

\* Refer to Winner Cartridge Valves Catalog.

|          |                         |
|----------|-------------------------|
| Aluminum | 1.35 kg(WITHOUT VALVES) |
|----------|-------------------------|

\* If you need the special specification.  
Please contact us.

### PORT SIZE

| X    | PORTS | PORT   |  |
|------|-------|--------|--|
|      | 1,2   | 3      |  |
| G08A | G 1"  | G 3/8" |  |

### Y BODY MATERIAL

**A** HIGH-STRENGTH ALUMINUM

### Z CARTRIDGE VALVES SELECTION

WITHOUT VALVE