

Ordering Code: **ML-33A4-X-Y 11-Z**

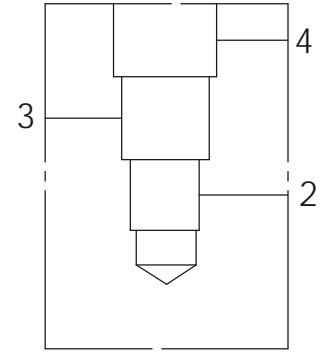
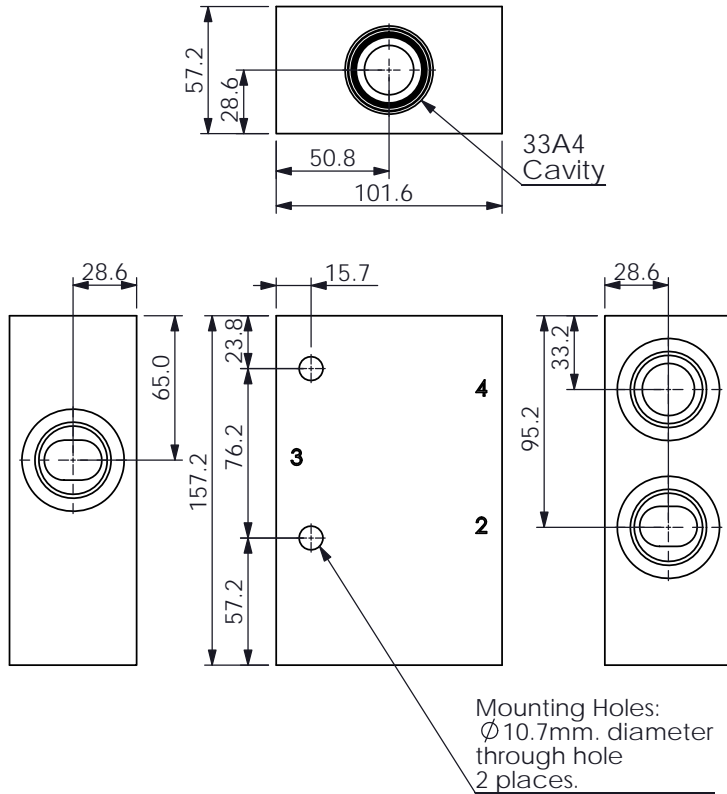

TECHNICAL DATA

Aluminum Body Pressure Rating: 210 bar
 Ductile Iron Body Pressure Rating: 350 bar

Cavity:

Refer to 33A4

* Refer to Winner Cartridge Valves Catalog.

Aluminum	1.95 kg(WITHOUT VALVES)
Ductile Iron	5.4 kg(WITHOUT VALVES)

* If you need the special specification.
Please contact us.

UNIT:mm

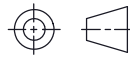

PORT SIZE

X	PORT	PORTS	
	3	2,4	
G08	G 1"	G 1"	

Y BODY MATERIAL

A HIGH-STRENGTH ALUMINUM

S DUCTILE IRON

Z CARTRIDGE VALVES SELECTION

WITHOUT VALVE